

# CANADIAN PECULIAR

GROUP 3

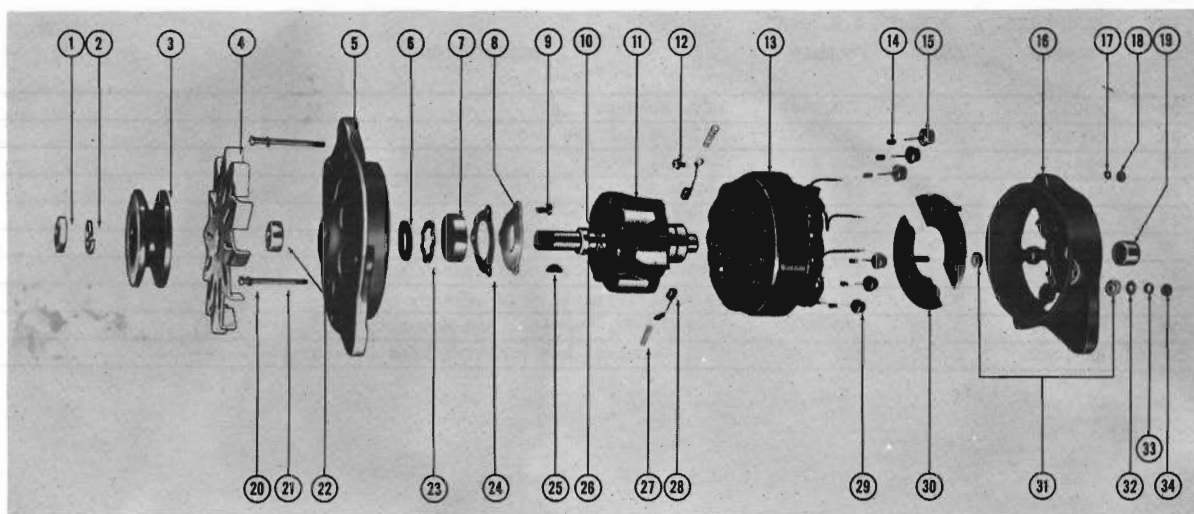

## ALTERNATOR

A.M. NO. 316 9168 (34 Amp.) 163-164 01-10-80  
 A.M. NO. 317 9259 (34 Amp.) 165 01 (LHE)(OHV-196): 165 10-80 (V8)  
 A.M. NO. 316 9474 (40 Amp.) 163-164 01-10-80: 165 01 (LHE)(OHV-196):  
 165 10-80 (V8)

AUTO-LITE NO. ALK-5101  
 AUTO-LITE NO. ALK-5001C  
 AUTO-LITE NO. ALE-5101A

KEY NO.	AUTO-LITE NUMBER	A.M. GROUP	A.M. PART NUMBER	DESCRIPTION	QUAN. REQ.
1	GBM-21B	3.010	311 2796	NUT, Rotor Shaft Drive End (Replaces 311 8776)	1
2	12X-864	3.010	311 8777	LOCKWASHER, Rotor Shaft Drive End Nut	1
3	PU-585	3.010	320 9013	PULLEY, Drive	1
4	PU-625	3.010	320 9014	FAN, Ventilating (Less Pulley)(34 Amp.)	1
4	PU-1605	3.017	320 9041	FAN, Ventilating (Less Pulley)(40 Amp.)	1
5	ALE-1003G	3.005	320 9015	HEAD, Drive End (34 Amp.)	1
5	ALE-1003	3.005	320 9052	HEAD, Drive End (40 Amp.)	1
7	X-3416	3.005	320 9016	BEARING, Ball	1
8	GJC 27C	3.005	320 9017	RETAINER, Bearing	1
9	8X-3427	3.005	320 9018	SCREW, Bearing Retainer (#10-32 x 1/2)	3
10	GAR-171	3.005	320 9019	RING, Snap	1
11	ALE-2006C	3.005	320 9020	ROTOR ASSEMBLY (34 Amp.)	1
11	ALE-2006	3.005	320 9043	ROTOR ASSEMBLY (40 Amp.)	1
12	X-3470	3.005	320 9021	SCREW, Ground Brush	1
13	ALE-2008D	3.005	320 9022	STATOR ASSEMBLY (34 Amp.)	1
13	ALE-2008	3.005	320 9044	STATOR ASSEMBLY (40 Amp.)	1
14	X-3554	3.005	320 9023	CLAMP, Stator Lead To Rectifier Wire	3
15	XA-944C	3.005	320 9024	DIODE, Negative	3
16	ALE-1002FS	3.005	320 9025	HEAD ASSEMBLY, Commutator End (34 Amp.)	1
16	ALE-1002AS	3.005	320 9045	HEAD ASSEMBLY, Commutator (40 Amp.)	1
17	12X-196	3.005	311 3686	LOCKWASHER, Mounting Stud Nut (#19) (Replaces 311 8964)	2
18	8X-173	3.005	320 9027	NUT, Mounting Stud (Hexagon)(#10-32)	2
19	X-3417	3.005	320 9028	BEARING, Roller	1
20	12X-196	3.005	311 3686	LOCKWASHER, Thr Bolt (Replaces 311 8964)	4
21	ALA-20C	3.005	320 9030	BOLT, Thru	4
22	ALC-21D	3.005	320 9031	SPACER, Rotor Shaft (34 Amp.)	1
22	ALD-21	3.005	320 9046	SPACER, Rotor Shaft (40 Amp.)	1